



## INSTRUCTION MANUAL

### Cat-Back Black Elite Split Rear Exhaust

RAM 1500 3.6L, Non- Turbo V6 2/4WD

Crew Cab, Short Bed 5'-7", Quad Cab, Standard Bed 6'-4"

### PART # 66572B

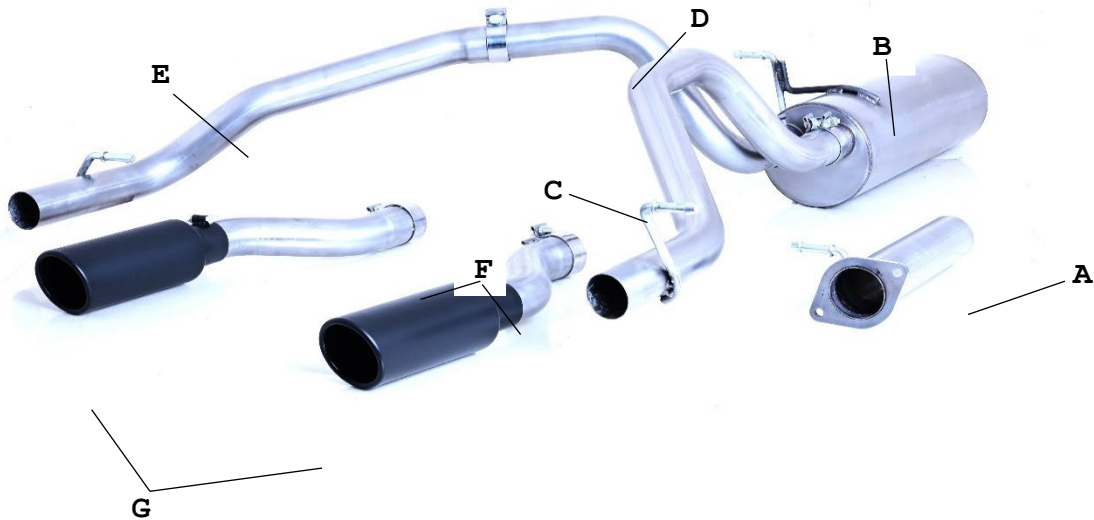

Item	Part Number	Quantity	Description
A	999701004S	1	3" Head Pipe
B	999701178s	1	Muffler Assembly
C	999701179s	1	2.5" PS Overaxle B
D	999701180s	1	2.5" DS Overaxle Pipe A
E	999701181s	1	2.5" DS Overaxle Pipe B
F	999701182s	2	Exit Pipe
G	500640-B	2	4" Rolled Black Round Angle Cut Tip
H	BO-1028	1	Bolt Kit for Head Pipe
I	BO-1092	1	Bolt Kit for Hanger Bracket
J	4346	1	Hanger Bracket
K	5762	5	2.5" Band Clamp
L	5763	1	3" Band Clamp

Thank you for purchasing our GIBSON PERFORMANCE EXHAUST SYSTEM for your vehicle.

If you need further assistance, please do not hesitate to call our technical department at

1-800-528-3044 Monday through Friday, 8:00 am to 5:00 pm

## CAREFULLY READ THE INSTRUCTIONS BEFORE INSTALLING THE PRODUCT

When installing this exhaust system make sure to use proper safety precautions. Therefore, make sure instructions are thoroughly read and understood before attempting to install. Use jack stands when working under the vehicle, set parking brake, block tires and use safety glasses and gloves. Allow exhaust system to cool before attempting installation. Severe injury or burns could occur if safety measures are not taken.

**SUGGESTED TOOLS:** Sawzall or hacksaw, 1/2", 14mm socket or wrench, 15mm deep socket or wrench. Hanger removal tool or large channel-lock pliers, WD-40 and Jack Stands.

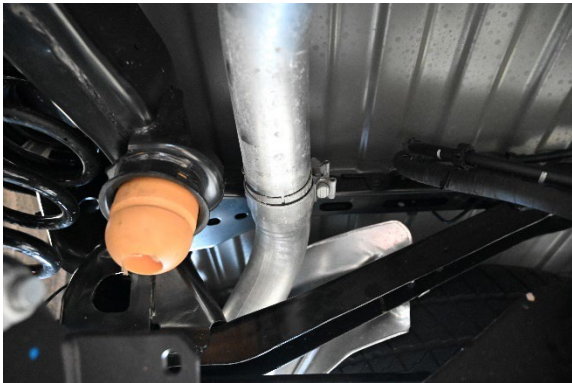

**1.** To remove the factory exhaust you will need to loosen the clamp located above the rear axle.

**2.** Once factory exhaust is removed you may install Headpipe **#A** using supplied bolt kit **#H**. Then attach ground cable to headpipe hanger.

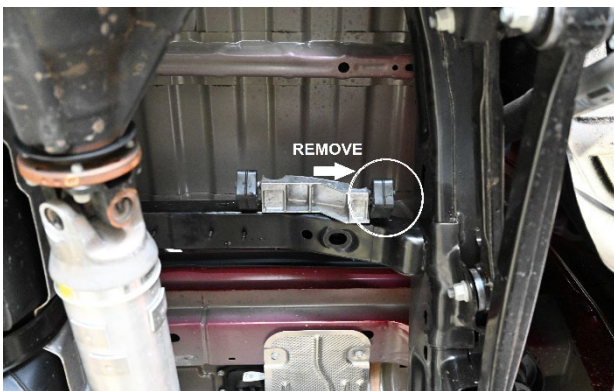

**3.** Next, remove passenger side rubber grommet used to mount muffler and install it on hanger bracket **#J**. Then install muffler assy. **#B** with supplied clamp **#L**.



**4.** Now, install PS Overaxle Pipe **#C** and DS Overaxle Pipe **A #D** with supplied clamps **#K** (**KEEP CLAMPS A BIT LOOSE AS THIS KIT HAS FLEXIBILITY WITH FITMENT**).





5. Then, install Hanger Bracket #J using supplied Bolt Kit #I on DS of frame. (Use sample photo for reference)

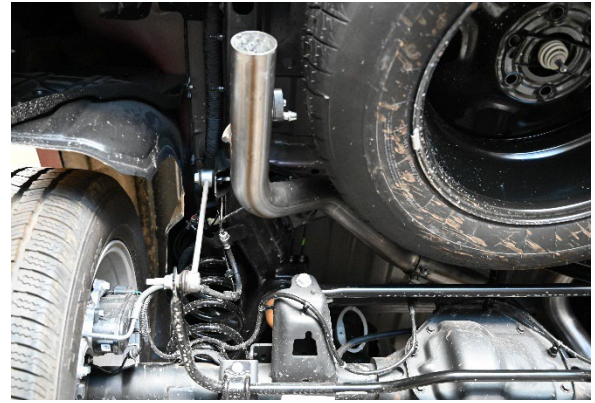

6. Once Hanger Bracket is secured you may install DS Overaxle Pipe B #E with supplied clamp #K. (CLAMPS ARE TO REMAIN A BIT LOOSE TO AID IN FINAL FITMENT)



7. Finally, install Exit Pipes #F with supplied clamps #K and Tips #G. Once Tips are in desired location you may begin to start tightening from front to back.



**NOTE, THESE EXIT PIPES WERE DESIGNED TO ALLOW THE CUSTOMER TO CHOOSE WHICH TIP LOCATION IS PREFERRED AND TO ALLOW THE KIT TO FIT ANY AFTERMARKET BUMPER**

GIBSON EXHAUST systems are designed on a factory stock vehicle. Any aftermarket products installed could increase the sound levels of this Exhaust. Make sure there is a 1" clearance from ALL rubber brake lines, shock boots, fuel lines, tires, etc. to prevent heat related damage or fire.